

- NOTES:
1. WATERMETER & HIGH HYDRANTS TO BE RELOCATED BY OTHERS.
 2. *- TO BE RELOCATED BY OTHERS
 3. REMOVE ALL TREES CLOSER THAN 5' TO CURB
 4. STREET SIGNS TO BE RELOCATED UNDER THIS CONTRACT
 5. ADJUST ALL SEWER MAINS TO GRADE
 6. ALL DRIVEWAYS TO BE CONCRETE PER CITY
 7. ALL SAN SEWER STS. TO BE 18" DIA.

DEPARTMENT OF ENGINEERING
CITY OF SAN BERNARDINO

FIFTH STREET
SIERRA WAY TO WATERMAN AVENUE
SURFACING, SIDEWALKS, CURB & GUTTERS

NESTLE, PACE & ASSOCIATES
CONSULTING CIVIL ENGINEERS
246 FIFTH ST. SAN BERNARDINO

DATE: 1/28/64
DRAWN BY: J.M.K.
CHECKED BY: H.M.P.
DESIGNED BY: H.M.P.

2584

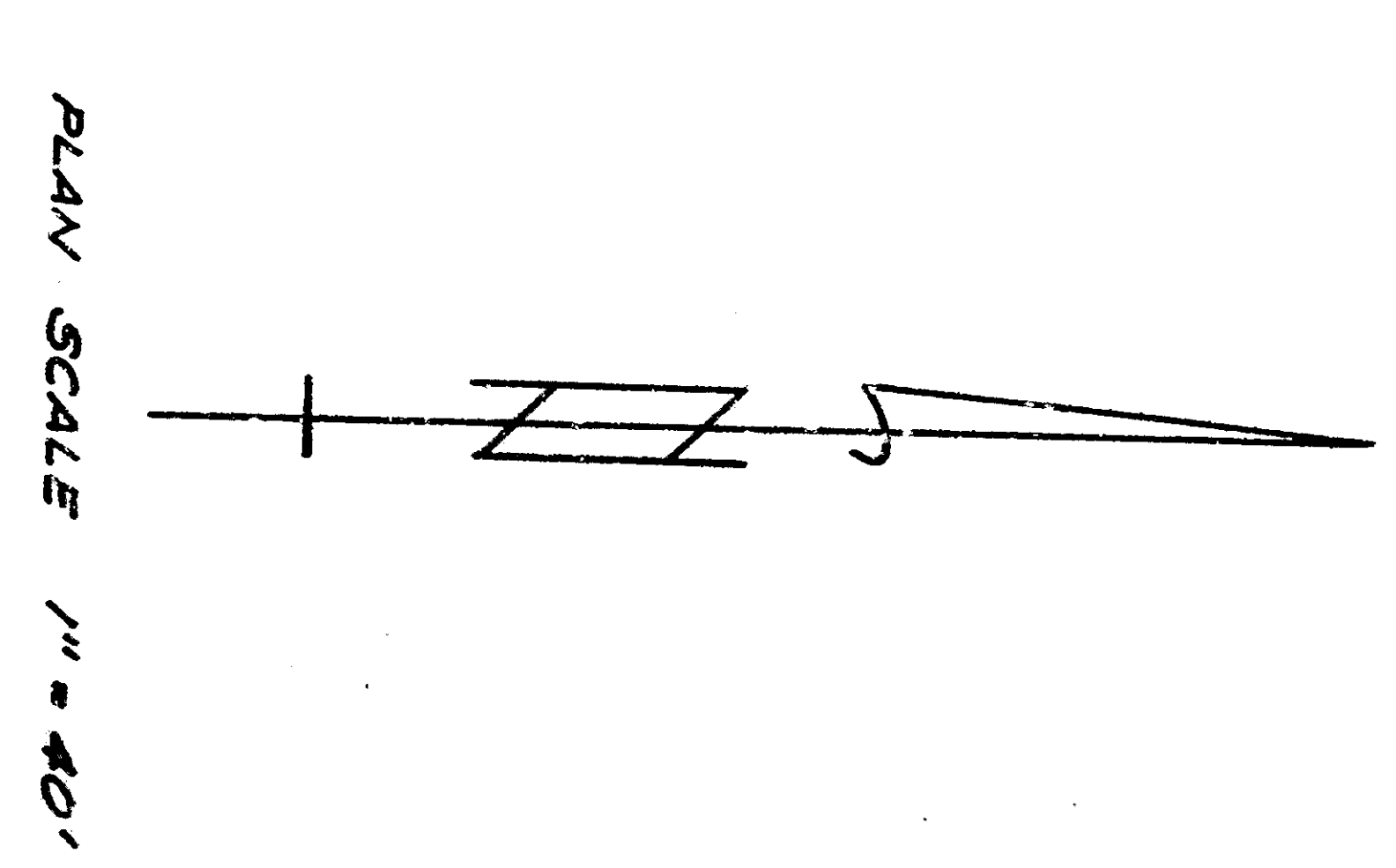

BENCH MARK
SCREW IN CURB AT
WATERMAN AVE. ST. 4
ELEV. 1038.1
ADJUSTED M.S.L.

DRAWING NO. 2584
 SHEET 1 OF 1
 DATE: 1/28/64
 CITY OF SAN BERNARDINO




- NOTES:
1. WATER MAINS & HIGH HYDRANTS TO BE RELOCATED BY OTHERS.
 2. *- TO BE RELOCATED BY OTHERS.
 3. REMOVE ALL TREES CLOSER THAN 5' TO CURB.
 4. STREET SIGNS TO BE RELOCATED UNDER THIS CONTRACT.
 5. ADJUST ALL SEWER MAINS TO GRADE.
 6. ALL DRIVEWAYS TO BE CONCRETE PER CITY OF SAN BERNARDINO STD. ENG. NO. 2321-E.

DEPARTMENT OF ENGINEERING
CITY OF SAN BERNARDINO

FIFTH STREET
SURFACING, SIDEWALKS, CURB & GUTTERS

NESTLE, PACE & ASSOCIATES
CONSULTING CIVIL ENGINEERS
246 FIFTH ST. SAN BERNARDINO

DATE: 1/28/78
DRAWN BY: J.A.M.
CHECKED BY: H.M. DE SHERBURN
REGISTERED CIVIL ENGINEER NO. 1217

DRAWING NO. 2584
SHEET 1 OF 2

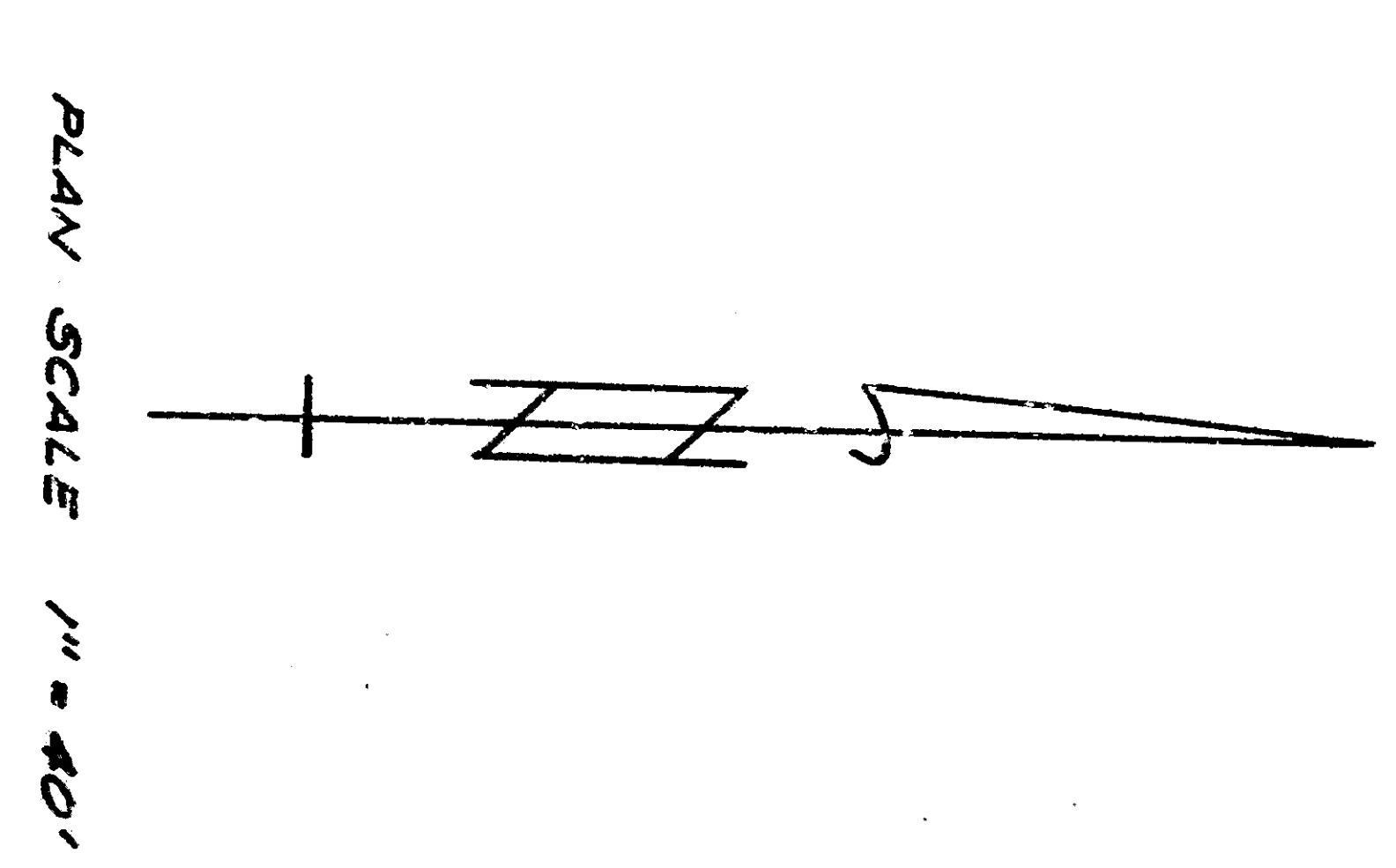

BENCH MARK
SCREW IN CURB MET.
WATERMAIN AVE. ST. 4
ELEV. 1032.1
ADJUSTED M.S.L.

DATE: 1/28/78
 DRAWN BY: J.A.M.
 CHECKED BY: H.M. DE SHERBURN
 REGISTERED CIVIL ENGINEER NO. 1217